

## ID Xpansion Spanner MITEE-BITE

Der ideale Spanner zur Mehrfachspannung in Bohrungen für Bearbeitungszentren. Lieferbar in 10 Größen für Bohrungsdurchmesser von 4,1–103 mm.

- Kompakte Konstruktion.
- Ideal für Zweitbearbeitung an Drehteilen.
- Einfach auf den gewünschten Durchmesser dreh- oder fräsbar.
- Ideal für Paletten.
- Mehrfachspannung reduziert Nebenzeiten.
- Spannhülse weich, bearbeitbar.
- Vergütete Spanschraube.
- Spannung mit Schlüssel oder mit Hilfe von Hydraulikzylinder.

## Dispositif de serrage ID Xpansion MITEE-BITE

Le dispositif de serrage idéal pour un serrage multiple dans des alésages pour centres d'usinage. Livrable en 10 dimensions pour des diamètres d'alésage de 4,1–103 mm.

- Construction compacte.
- Idéal pour la reprise d'usinage de pièces tournées.
- Simplement tournable et fraisable au diamètre souhaité.
- Idéal pour les palettes.
- Serrage multiples réduisant le temps improductif.
- Douille de serrage tendre, usinable.
- Vis de serrage traitée.
- Serrage avec une clé ou à l'aide d'un vérin hydraulique.

## ID Xpansion Clamp MITEE-BITE

The ID Xpansion clamp is the ideal way to hold multiple parts on an inside diameter for high density machining on vertical or horizontal machining centers. It can also be used as an expanding mandrel on a lathe.

These machinable clamps are produced in 10 sizes and can hold internal diameters from under 4.1mm to over 103mm.

The flange diameter of the clamp is held to a close tolerance for precision locating in a machined pocket on work cubes and fixture plates.

The customer machines the mild steel clamp to match the bore of the part ensuring a proper fit. Often times the clamps can be remachined for different size jobs.

One of the benefits of these low profile clamps is holding many lathe parts, for secondary machining, on one compact set up. They are quickly tightened with a hex key, torque driver or can be mated to hydraulic pull cylinders for automation.

- Low Profile
- Ideal for Secondary Operations on Lathe Parts
- Easily Machined to Size on Lathe or Mill
- Excellent for Palletized Setups
- Allows More Parts Per Workcube or Fixture Plate
- Heat-treated and Coated Screw for Long Life
- Clamp Body Made of Mild Steel for Machinability
- Tighten with Hex Key or Hydraulic Pull Cylinders/Speed Block
- Longer Screws for Hydraulic Applications Available

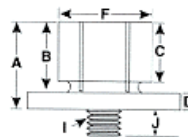
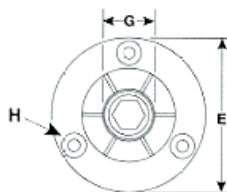
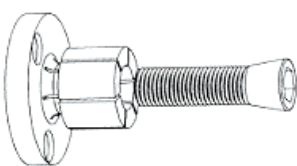

## Technische Daten: ID Xpansion Spanner Données techniques: Dispositif de serrage ID Xpansion Technical specifications: ID Xpansion Clamp

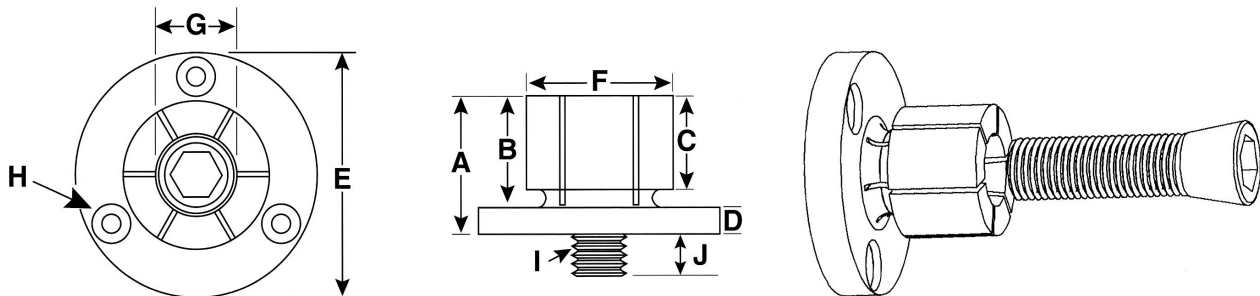

Art. Nr.	Modell Modèle Model	A mm	B mm	C mm	D mm	E 0-0.05 mm	F mm	G mm	H	I	J mm
26-38000	38000	10.7	7.6	6.1	3.0	20.0	7.4	4.1	3 x M2 / Teilkreis 13.7 3 x M2 / Cercle de division 13.7 3 x M2 / Pitch circle 13.7	M2	4.1
26-38050	38050	21.8	16.0	15.0	5.9	29.7	12.4	8.0	3 x M3 / Teilkreis 21.0 3 x M3 / Cercle de division 21.0 3 x M3 / Pitch circle 21.0	M4	7.2
26-38100	38100	25.0	19.0	15.0	5.9	31.5	14.0	12.2	3 x M3 / Teilkreis 23.1 3 x M3 / Cercle de division 23.1 3 x M3 / Pitch circle 23.1	M6	11.2
26-38150	38150	25.0	19.0	15.0	5.9	37.5	20.0	13.5	3 x M3 / Teilkreis 29.0 3 x M3 / Cercle de division 29.0 3 x M3 / Pitch circle 29.0	M8	13.2
26-38200	38200	28.5	22.0	17.5	6.4	50.0	27.0	18.0	3 x M4 / Teilkreis 39.4 3 x M4 / Cercle de division 39.4 3 x M4 / Pitch circle 39.4	M10	16.3
26-38250	38250	32.0	25.5	20.5	6.4	56.0	35.0	23.0	3 x M4 / Teilkreis 45.5 3 x M4 / Cercle de division 45.5 3 x M4 / Pitch circle 45.5	M12	20.3
26-38300	38300	39.5	32.0	27.0	7.9	69.5	42.0	29.3	3 x M5 / Teilkreis 55.9 3 x M5 / Cercle de division 55.9 3 x M5 / Pitch circle 55.9	M16	21.4
26-38350	38350	39.5	32.0	27.0	7.9	75.5	51.0	29.3	3 x M5 / Teilkreis 63.9 3 x M5 / Cercle de division 63.9 3 x M5 / Pitch circle 63.9	M16	21.4
26-38400	38400	45.5	37.5	32.3	7.9	107.5	77.0	29.3	3 x M6 / Teilkreis 92.6 3 x M6 / Cercle de division 92.6 3 x M6 / Pitch circle 92.6	M16	19.3
26-38450	38450	45.5	37.5	32.3	7.9	132.9	103.0	29.3	3 x M6 / Teilkreis 118.0 3 x M6 / Cercle de division 118 3 x M6 / Pitch circle 118.0	M16	19.3

G: Kleinstmöglicher Durchmesser F  
Plus petit diamètre possible F  
Minimum diameter the F dimension can machined or turned down to

H: 3 Befestigungsschrauben inklusiv  
3 vis de fixation comprises  
3 mounting screws included

